



*We Have Lots of Robots, But Still None Like This..*

**Midwestcon 58 – The Relaxacon**  
**Doubletree Guest Suites, Cincinnati**  
**June 21 – 24, 2007**

# KANSAS CITY IN 2009

## A BID FOR THE 67TH WORLD SCIENCE FICTION CONVENTION LABOR DAY WEEKEND—SEPTEMBER 3-7, 2009

*Help Bring the Stanley Cup to Kansas City!*



*Jazzfire Phoenix by Rachael Mayo*

OK, it works like this: in 2003, the Site Selection vote was held in a foreign country (that would be Canada, home of the Naked News), and Los Angeles beat Kansas City in a close vote. Los Angeles held the Worldcon in 2006 in Anaheim, and the following year the Anaheim Mighty Ducks won the Stanley Cup.

So now, in 2007, the Site Selection vote is in a foreign country (Japan, home of the Hello Kitty vibrator), and Kansas City is competing against Montréal. Obviously, history shows the winner of this vote will have their city claim Lord Stanley's oversized spitoon in 2010. All you have to do is vote for us, and we'll take care of having an actual hockey team here by then.

*YOU'LL GET THE THE BENEFITS LISTED BELOW FOR PRESUPPORTING  
IF YOU VOTE AND WE WIN.*

**Presupport: \$20 US**  
supporting membership  
1/2 credit for conversion

**Preoppose: \$25 US**  
supporting membership  
1/2 credit for conversion

**Friend of the Library: \$50 US**  
attending membership  
listing in program book

**Patron: \$100 US**  
attending membership  
listing in program book; bid t-shirt & more

*For the latst info, check out our updated Website: [www.kc2009.org](http://www.kc2009.org)  
Questions? Comments? Just want to chat? Our email address is: [masffc@kc.rr.com](mailto:masffc@kc.rr.com)*

Make checks (in U.S. funds) payable to Kansas City in 2009 and mail to:  
Kansas City 2009, P.O. Box 414175, Kansas City, MO 64141-4175

Service Mark notice: "World Science Fiction Society," "WSFS," "World Science Fiction Convention," "NASFIC," "Hugo" and "WorldCon" are registered service marks of the World Science Fiction Society, an unincorporated literary society.

## Letter from the Editor

Welcome back to Cincinnati, and to the  
Doubletree Guest Suites.

There are two Cincinnati events coinciding  
with Midwestcon this year – see “Main  
Tourist Attractions” for info. Please let me  
know in your comments if such events are  
of interest to the members? The menu book  
and restaurant guide have been revised  
again this year. Note that two of the  
restaurants “A Little Further Afield” in last  
year’s guide have closed, so please check  
this year’s guide. As always, a drop box for  
comments will be in the Consuite. Thanks,  
and enjoy relaxing with the Cincinnati  
Fantasy Group.

Deborah Oakes, aka CFG scribe

Cincinnati Fantasy Group Website: [www.cfg.org](http://www.cfg.org)

Webmaster: Scott Street, [webgeek@cfg.org](mailto:webgeek@cfg.org)

President/CFG Dictator: Bill Cavin, [dictator@cfg.org](mailto:dictator@cfg.org)

Sec.Tres./CFG Scribe: Deborah Oakes, [scribe@cfg.org](mailto:scribe@cfg.org)

Art Show Director: Michael Jordan

Art Show Staff: Roger Jordan

ConSuite Directors: Becca Levin and Guy Allen

Consuite Staff: Drew McDonald, Scott Street

Registration: Carol Resnick,

Margaret Keifer, Yvonne Berger, Cokie Cavin

Dealer’s Room: Larry Smith

Program Book Contributor: Joel Zakem

# Convention Info

The **Dealer's Room** is in the Ballroom (south), on the Lobby level, beyond the Bistro café. **Hours are 5 - 8 pm Fri., 11 am - 6 pm Sat., and 11 am - 2 pm Sun.**

The **Art Show** is also on the Lobby level, and shares quarters (and hours) with the Dealers Room. **The Art Auction will be at 7 PM. on Saturday**, on the patio outside the ballroom, if required. Any bid will send an item to Auction.

The **Con Suite** is located in the ballroom (north). *On Friday evening at 8:30 pm, we will be sponsoring a **Brownie Bash** in the consuite - please join us.*

**Registration** is in the Consuite. **Hours are 6 - 10 pm Thurs, 10 am - 5 pm and 7 pm - 9 pm Fri, and 10 am - noon Sat.**



# DOUBLETREE GUEST SUITES™

CINCINNATI

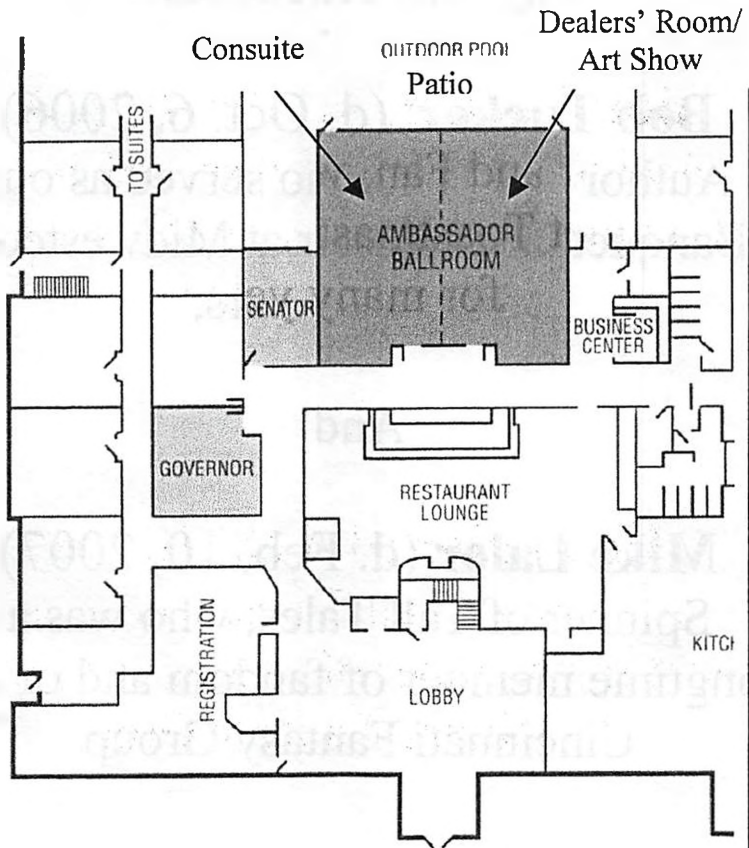

# *In Memoriam*

This year Midwestcon has lost two  
long time Attendees –

**Bob Tucker**, (d. Oct. 6, 2006)  
Author and Fan, who served as our  
Banquet Toastmaster at Midwestcon  
for many years,

And

**Mike Lalor** (d. Feb. 10, 2007)  
Spinner of Tall Tales, who was a  
longtime member of fandom and of the  
Cincinnati Fantasy Group

*To Absent Friends*

## Main Tourist Attractions

1. **Cincinnati Art Museum, Eden Park**, Hours: 11 am-5 pm Tues-Sun except until 9 pm Weds, Closed Monday. Free. Directions: Take I-275 East to I-71 South. Exit at Gilbert Ave/Reading Rd. Turn left at the exit, then continue straight into Eden Park.
2. **Cincinnati Museum Center at Union Terminal, (Cincinnati History Museum, Cincinnati Natural History Museum, Cincinnati Children's Museum, Omnimax Theatre)**, Hours 10 am-5 pm Mon - Sat, 11 am – 6 pm Sun. Admission to any one museum/theatre \$7.25, seniors \$6.25, children ages 3-12 \$5.25. Add \$3 to adult admission for each additional attraction, \$2 for each child. Parking \$5. Anyone planning to see the Omnimax movie is advised to purchase tickets on arrival before touring the museum (s). Directions: Take I-275 West to I-75 South. Exit I-75 South at Ezzard Charles Drive. The museum is on the right at the first light. When you leave the museum go straight, the entrance to I 75 North is across the highway on the left.
3. **Cincinnati Zoo and Botanical Gardens, 3400 Vine Street**, Hours 9 am – 6 pm Sun- Fri, 9 am — 8 pm Sat.. Admission \$12.95 (\$10.95 on line), seniors \$10.95, (2-12) \$7.95. I-275 West to I-75 South. Exit at Mitchell Ave. Turn left at the exit and then right on Vine Street (the second light). Turn left on Forest Ave and right on Drury to reach the vehicle gate. (Signs for the zoo begin on Vine St.).
4. **Kings Island**. Hours 10 am – 10 pm. Admission \$44.95, seniors and children 3-6 \$29.95.

(You can save 25% on admission by ordering tickets online, up to 30% for three day advance purchase)  
Parking \$10. Directions: Take I-275 East to I-71 North, exit at Western Row Road and follow the signs.

**5. Newport Aquarium, Newport Levee, Hours 9 am – 7 pm, Sun- Fri, 9am – 9 pm Sat. Admission \$17.95, seniors \$15.95, children 2-12 \$10.95, Parking \$3-5.**  
Directions: Take I-275 East to I-71 South to I-471 South. Take exit 5 - Newport Bellevue Route 8. Turn left at the bottom of the exit ramp. Proceed straight into the Newport on the Levee Parking Garage.

**6. Argosy Casino, Lawrenceburg, Indiana.** Now open 24 hours. Directions: I -275 West to the Route 50 West exit at Lawrenceburg, Indiana. Take Route 50 west to Argosy Parkway. Turn Left on Argosy Parkway and follow the signs.

**7. Contemporary Arts Center, 44 E. 6<sup>th</sup> St., Cincinnati.** Hours for paid admission: 10 am – 6 pm Mon, Weds-Fri, 11 am – 6 pm Sat-Sun. Closed Tues. Adults \$7.50, Seniors \$6.50, Students \$5.50, Children 3-13 \$4.50 Directions: Take I-275 east to I-71 south to the Gilbert Ave. exit. Go west on Gilbert, it will turn into 8<sup>th</sup> St. Turn left on Walnut. The Center is on the right at 6<sup>th</sup> and Walnut. Parking is available at Fountain Square garage, with access from Walnut or Vine streets.

**8. National Underground Railroad Museum, 50 E. Freedom Way, Hours 11 am – 5 pm Tues-Sun, Closed Mon.** Directions: Take I-275 west to I-75 South to the Second Street exit. You will drive straight past the Museum (on the right) and turn right on Main. Turn right on Mehring Way, Right on Central, then right on Pete Rose Way to reach the Central Riverfront Garage.



***Due to Fortunate Timing, Two Special Attractions are Available to those Interested this Year – Cincinnati's Playhouse in the Park is currently performing a play, and Cincinnati's yearly home show is in progress, and is located conveniently close.***

**7. Playhouse in the Park** – “Smoke on the Mountain” Thompson Shelterhouse Theater, Eden Park, Times: 8 pm Thurs-Fri, 5 and 9 pm Sat, 2 and 7 pm Sun. Tickets \$40.50-\$56.50 Directions: Follow the directions to Eden Park listed under the Cincinnati Art Museum. The Playhouse is on the same road as the Art Museum, beyond the entrance to the museum.

**8. Homerama**, – Every year, Cincinnati builders sponsor a home show of multimillion dollar homes which can be toured for a fee. The homes are fully decorated and landscaped. This year there are 10 homes that those interested can tour for a \$12 fee. (Allow 3 Hours During Peak Times!) There are several ways to reach Homerama.

**Take I-275 east to Montgomery road north. Follow the signs to Homerama at the Vintage Club – on the right..Turn left out of the parking lot onto Kemper, follow Kemper for 3 miles to Montgomery Road. Turn right at Montgomery and follow the signs for Homearama – the Vintage Club will be on the left.**



# DENVENTION 3

**The 66th World Science Fiction Convention**

**August 6-August 10, 2008**

**Denver, Colorado, USA**

**Colorado Convention Center**

<http://www.denverconvention.com>

Lois McMaster Bujold – Guest of Honor

Rick Sternbach – Artist Guest of Honor

Tom Whitmore – Fan Guest of Honor

Robert Heinlein – Ghost of Honor

Wil McCarthy - Toastmaster

**For membership**

**or additional information**

**see our web page or send an email**

<http://denvention3.org> • [info@denvention3.org](mailto:info@denvention3.org)

Denvention 3

P.O. Box 1349, Denver, CO 80201



**Check out our installment plan!**

Lock in today's low membership rate  
and pay it off over time.



Service Mark Notice: "World Science Fiction Society", "WSFS", "World Science Fiction Convention", "Worldcon", "NASFIC" and "Hugo Award" are registered service marks of the World Science Fiction Society, an unincorporated literary society.

# APPROACHING NUMBER 40: AN INVITATION

By Joel Zakem

(who feels much to young to have attended 40 MidWestCons)

It's early June 2007 and, as I am writing this, nostalgia is running rampant. It is difficult to pick up the entertainment section of a newspaper or to listen to the radio without hearing some reference to the 40<sup>th</sup> anniversary of the release of "Sergeant Pepper." While June of 1967 is a significant date in the realm of rock music, I want to look back at an event that occurred slightly over a following Sergeant Pepper's release (and thus 21 years after he taught the band to play) that might well have a bit more significance for a group of then 15 year olds.

Actually, the story begins somewhat earlier than June of 1968, even though I am not sure of the exact date (it was probably in late 1967 or early 1968). I do know that it started in a used bookstore in downtown Cincinnati. I was there with my friend, Earl Whitson, and we (or at least I) were looking through a table of old digest sized science fiction magazines. Two other kids around our age, Brad Balfour and Frank Johnson, approached the table and we began talking, discovering that we (at least at that time) shared a love of SF.

Through fortuitous circumstances (Brad's father knew Lou Tabakow through the dry cleaning business and, after learning that Brad liked science fiction, Lou

told Brad's father about MidWestCon), this meeting led to that faithful Saturday in June 1968 when the four aforementioned 15 year olds journeyed to the North Plaza Motel in order to attend, at least for a day, their first SCIENCE FICTION CONVENTION, MidWestCon 19.

Brad and Earl drifted away, but Frank and I have managed to attend every MidWestCon since. For the non-math majors out there, this means that the 2007 MidWestCon will be our 40<sup>th</sup>. Which, if nothing else, is a good excuse for a party.

It has never been the biggest con (though it would be nice if it got a bit bigger), but in many ways MidWestCon has always been the convention I am most comfortable at. While MidWestCon still attracts some big name pros and fans, I find very little pretension there. Even as a very shy 15 year old, I got to talk to Fritz Leiber at my first MidWestCon.

The setting has changed (several times). Beer (for which I can take a small degree of credit) and wine have been added to the mix of hard liquor in the con suite. Still, in many ways, the spirit that I discovered at my first few MidWestCons remains.

Therefore I am finding it difficult to point out very many differences between the MidWestCon of 1968 and the MidWestCons of recent years. Sure, some of the people have changed. We have lost so many

of the locals like Lou, Bea Mahaffey, Dale Tarr, Mike Lalor and so many others who helped make a bunch of 15 year olds welcome. I also miss people like Lynn Hickman, Bob Tucker, Howard Devore and the many others who shared the stories of fans and fandoms passed.

Though MidWestCon may have decreased in size over the past several years, it is the quality, and not the quantity, of the people that keep me coming back. I have met many of my dearest friends in fandom at MidWestCon, and I can count on many of them being there each and every June. Moreover, I have fallen in and out of love (or at least lust) at several past MidWestCons (and I have not given up yet).

In many ways, having MidWestCon as my introduction to SF cons has spoiled me. While it is not the only con that I attend and enjoy, it is still the one that I most look forward to attending. I always know that the last full weekend in June is the time for coming back to Cincinnati to party with some of the people who are most important to me.

And speaking of parties (as I have at least twice), Frank and I are having one to celebrate the occasion. It is tentatively scheduled for Friday Night in the Buckeye Suite on the second floor. There will (hopefully) be signs for those of you who did not read this until after the con. Otherwise, just look for Frank and me.

## Local Shopping and Incidentals

**1. Drugstore** – the nearest full service drugstores are the **CVS Pharmacy** and the **Walgreens**, one exit west (Highway 42) on I-275. Turn right after exiting the highway. **CVS** is one block north, **Walgreens** is two blocks beyond, next to Kroger's. **CVS** is open 24 hours. Hours at the **Walgreens** are 7 am-10 pm weekdays, 8 am – 10 pm weekends. Pharmacy 8 am – 10 pm Mon-Fri, 9 am – 6 pm Sat, 10 am – 6 pm Sun. In case of emergency, there is a 24 hour **Walgreens** at the Tylersville exit on I-75 north of I-275.

**2. Grocery Stores** - The nearest grocery store is the **Kroger**, one exit west (Highway 42) on I-275. Turn right at the exit, Kroger's is 3 blocks north. Hours 5 am – 1 am 7 days a week. For those wishing a discount party supply store, there are several large discount stores at the Fields-Ertel road exit of I – 71 north. Take I-275 east to I-71 north. Fields-Ertel is the first exit north of I-275. (Warning – High congestion area!) The nearest discount store is the **Biggs** superstore – turn left at the exit and proceed through the intersection and under the highway. The **Biggs** will be .25 mile ahead on your right. Both a **Meijers** and a **Costco** are also accessible from this exit – turn left at the exit and right on Fields-Ertel. For what is undeniably the most unique and varied grocery in Cincinnati, you must go a little farther afield. **Jungle Jim's** is a mecca of fresh produce and ethnic/imported specialties. **Jungle Jim's** originated as a produce market but now includes a grocery, a deli, a bank, a bakery, a state licensed liquor store and a pharmacy with a first for Cincinnati – an "Oxygen Bar". Finally a truly incredible selection of ethnic foods from all over the world

of ethnic foods from all over the world is available  
Hours: 8 am – 10 pm, 7 days a week. Pharmacy  
9am – 7 pm Mon-Fri, 9 am – 5 pm Sat-Sun.  
Directions: Take I-275 west to Route 4 (Fairfield)  
north. Jungle Jim's is approximately 4 miles north  
of I-275 on the right. Look for the monorail cars  
above the front of the store.

3. **Liquor Store** – hard liquor can be bought only  
from state licensed stores in Ohio, although wine  
and beer are available at many full service grocery  
and discount stores. The nearest liquor store is  
**Twig's Liquor Agency**, at 11018 Reading Rd in  
Sharonville Hours: 9 am – 8 pm Mon – Sat.  
Directions: Take I-275 west to exit 46 (Highway  
42) Proceed south to Sharon Road and turn left.  
You are now on Reading Road. **Twigs** is on the  
left, in the first block.
4. **Shopping:** For those interested in a break, two  
shopping malls are in easy reach – **Tri-County  
Shopping Mall**, a two story modern mall with the  
usual complement of suburban stores, and the  
upscale **Kenwood Towne Center**. **Tri-County  
Mall** is reached via I-275 west to the Route 747  
south exit. Turn right at the exit, the mall is on the  
left. **Kenwood Towne Center** is reached via I-  
275 east and I-71 south. Take the Montgomery  
Road exit, then right at the exit to the first light  
Those with an interest in antiques will also find an  
**Antique Mall** at the Route 747 north exit. Go  
straight at the exit 1.5 blocks to Cresentville Rd.  
Turn right, the mall is 1.5 blocks ahead on the left  
(hours 9am – 9pm, 7 days).

- 5. Book Stores** – The nearest and best place to look for books is of course our own **Dealer's Room**, both for current science fiction/fantasy and for older material. If, however, you cannot find what you are looking for or have a significant other along with different tastes, the nearest bookstore is the **Barnes and Nobles** at the Fields-Ertel exit off I-71. Hours: 9 am – 10 pm, 7 days a week. Directions: I-275 east to I-71 north to the Fields-Ertel exit, turn left at the exit and right on Field-Ertel Rd. The bookstore will be 4 lights ahead on the left. For older material, Cincinnati has two specialty bookstores: **Ohio Bookstore**, 726 Main, Hours 9 am – 4:45 pm, Mon-Sat, Directions: Take I-275 east to I-71 south to the Gilbert Ave exit. Going west Gilbert becomes 8<sup>th</sup> street. The **Ohio Bookstore** is near 8<sup>th</sup> and Main. The other specialty bookstore is **Duttenhofer's Books**, at 214 W. McMillan. Hours: 10 am – 9 pm Mon – Fri, 10 am – 6 pm Sat, 11 am – 6 pm Sun. Directions: Take I-275 east to I-71 south to the Taft Rd exit. Follow Taft until it dead ends at Clifton. Turn left at Clifton and then left one block later onto McMillan. **Duttenhofer's** is on the left in the first block. To return to the hotel follow McMillan east to the ramp to I-71 north.
- 6. Cinema** For those interested in seeing any of the recent science fiction/fantasy films, an 18 screen cinema (one an IMAX) with stadium style seating is available nearby. Directions: Take I-275 west to the Route 4 exit. Stay in the right hand lane for entrance to the cinema. A listing of current shows and times will be available in the consuite menu book.



# WINDY CON 34

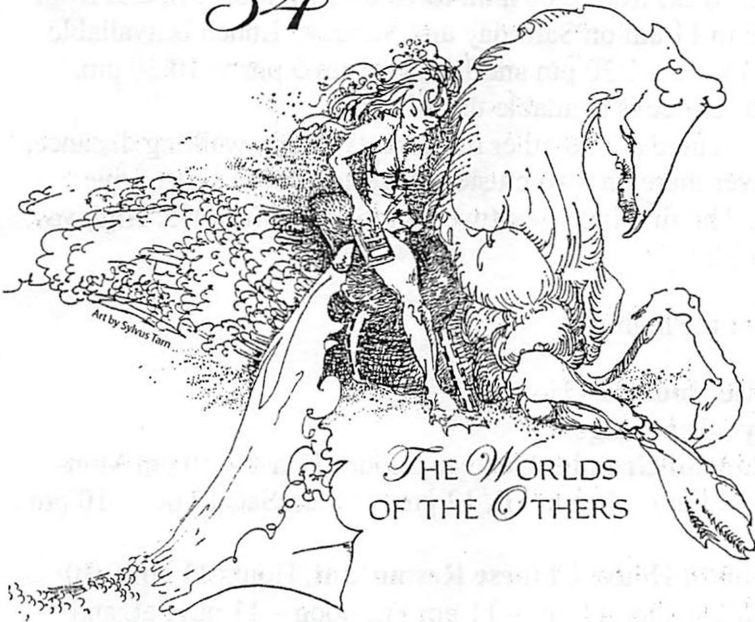

THE WORLDS  
OF THE OTHERS

TANYA HUFF  
AUTHOR CoH

TONI WEISSKOPF  
EDITOR CoH

JODY LEE  
ARTIST CoH

GEORGE PRICE  
FAN CoH

RICHARD CHWEDYK  
TOASTMASTER

MIKE RESNICK  
SPECIAL GUEST

NOVEMBER 9-11, 2007  
THE WYNDHAM O'HARE HOTEL  
ROSEMONT, ILLINOIS

[WWW.WINDYCON.ORG](http://WWW.WINDYCON.ORG)

# Northern Cincinnati Restaurant Guide

The **Doubletree** has a very nice café/lounge called the **Bistro** on the **Lobby** level. The **Bistro** serves a breakfast buffet 7 days a week, from 6:00 a.m. to 10:00 a.m. Mon-Fri, and from 7 a.m. to 11 am on Saturday and Sunday. Lunch is available from 11 am – 1:30 pm and Dinner from 5 pm to 10:30 pm. Room service is available until 11 pm.

There are no other restaurants within walking distance, however there are two clusters of restaurants a short drive away. The first is one exit west of the hotel (exit 46, Highway 42 on I-275).

South of the highway:

1. **Waffle House**, 24 Hours.
2. **Rally's Hamburgers**.
3. **El Rancho Grande**, Mexican, Hours: 11 am – 10 pm Mon-Thurs, 11 am – 11 pm Fri, 12 pm – 11 am Sat, 12 pm – 10 pm Sun.
4. **Szechuan House Chinese Restaurant**, Hours 11 am-9:30 pm Mon-Thurs, 11 am – 11 pm Fri, noon – 11 pm Sat, and noon – 9 pm Sun.
5. **Arby's**, Hours 10 am – 9 pm Sun-Thurs, 10 am – 9:30 pm Fri-Sat
6. **LaRosa's Pizzeria**, Italian, delivery 347-1111. Hours. Dining Room :10:30am – 10 pm Mon- Thurs, 10:30 am –12 am Fri-Sat, 12 pm-10pm Sun, Delivery available for an additional hour after the dining room closes, 347-1111

North of the highway:

7. **McDonald's**. 24 Hour Drive thru.
8. **Kentucky Fried Chicken**. Hours: 10:30 am – 10 pm Sun-Thurs, 10:30 am – 11 pm Fri-Sat.
9. **White Castle**, 24 hours.
10. **Perkins Family Restaurant**, Hours 6 am – 11 pm Sun-Thurs, 6 am – 12 am hours Fri-Sat.

North of the Highway(cont.)

11. **Wendy's**, Hours 10 am – 10 pm, Drive thru until 12 am Mon-Thurs, 1 am Fri-Sat
12. **House of Sun**, Chinese, Hours: 11 am – 9:30 pm Mon-Thurs, 11 am – 10 pm Fri-Sat, 10 am – 9pm Sun.
13. **The Red Squirrel**, large deli sandwiches, Hours 7 am – 8 pm Mon-Thurs, 7 a.m. – 9 p.m. Fri-Sat., 7 am 8 pm.,Sun.
14. **Chase Grill**, American.
15. **Skyline Chili**, Hours 10:30 am – 10 pm . Drive thru open until 11 pm Sun-Thurs, 12 am Fri-Sat.
16. **Taco Bell**, 10 am – 10 pm ,7 days,drive thru until 2 am
17. **Dunkin Donuts**, 24 hours
18. **Quiznos Subs**, gourmet subs, Hours 10 am – 9:30 pm Mon-Fri, 11 am – 8 pm Sat-Sun.
19. **New Krishna**, Indian Food, 11:30-2:30 Mon-Fri, Dinner 5 pm-10 pm Mon-Fri, Lunch 11:30 - 4 pm, Dinner 4 pm – 10 pm Sat, Lunch 12 pm - 4 pm, Dinner 4 pm – 9 pm Sun.

The second cluster of restaurants is located south of the hotel near the junction of Cornell and Reed Hartman Hwy.

Going east on Cornell:

20. **Decent Deli**, Hours: 9:30 am – 4:30 pm, Mon – Weds, 10 am – 8 pm Thurs-Fri, 10:30 am – 3 pm Sat, Closed Sun.
21. **Arby's**, 8 am – 9 pm Mon-Fri, Drive Thu 6 am-10 pm Closed Sun.
22. **White Swan Chinese Restaurant**, 10:30 am – 9:30 pm Mon-Fri, 4 am -10 pm Sat., 5 pm- 9 pm Sunday.
23. **Skyline**, hours:10:30 am – 9 pm Mon-Fri, 11 am – 7 pm Fri, 11:30 am – 4 pm
24. **Subway**, Hours:10 am – 10 pm 7 days.

On the Northeast corner of Cornell and Reed Hartman

25. **Starbuck's Coffee**, Hours 5:30 am – 11 pm Mon-Fri, 5:30 am – 12 am Sat, 6 am – 11 pm Sun
26. **Johnny Chan Buffet**, Delivery, Hours: 11 am – 10 pm, Sun-Thurs, 11 am – 10:30 pm Fri-Sat. Delivery 469-9898..
27. **Jersey Mike's Submarines**, Hours 10 am-8 pm, Mon- Thurs, 10 am – 9 pm Fri, 11 am – 3:30 pm Sat, closed Sun.

Going west on Cornell:

28. **McDonald's**. Hours 5 am-10 pm Mon-Fri, 6 am – 8 pm Sat., 7 am – 8 pm Sun.
29. **Gold Star Chili**, Hours 10 am – 9 pm Mon-Fri, 11 am – 5 pm Sat, Closed Sun.
30. **Bonnie Lynn Bakery and Restaurant.**, Hours:Restaurant 6 am -2:30 pm Mon-Fri, 6 am-1:30 pm Sat, 7 am- 2 pm Sun. Bakery 4:30 am – 6 pm Mon- Fri, 4:30 am – 3 pm Sat, 7am – 2 pm Sun.
31. **McAllister's Deli**, Hours: 10:30 am – 8 pm, Mon- Sat, 10:30am- 3 pm Sun.

On the northwest corner of Cornell and Reed Hartman:

32. **Chipotle**, Hours 11 am – 10 pm.
33. **Ruby Tuesday**, Hours 11 am – 11 pm Mon-Thurs, 11 am – 12 am Fri-Sat, 11 am – 10 pm Sun.
34. **Caribou Coffee**, Hours 5:30 am – 10 pm Mon-Thur., 5:30 am – 11 pm Fri, 6:30 am – 11 pm Sat., 6:30 am – 10 pm Sun.
35. **Quizno's Subs**, Hours 10 am – 8 pm Mon-Fri, 11:30 am – 8:30 pm Sat. Closed Sun.

South of Cornell on Reed Hartman:

- 34 **Wendy's**, 10:30 am – 10 pm Sun-Thur, 10:30 am – 11 pm Fri-Sat, Drive -thru until midnight.
35. **Panera Bread Co.**, soups, panini, deli, bakery, Hours 6 am – 8 pm Mon – Sat, 7:30 am – 4 pm Sun.
36. **Roly Poly**, rolled sandwiches, Hours 10 am – 6 pm Mon – Fri, 11 am – 3 pm Sat, closed Sun. Delivery 794-1111

## **A Little (or a Lot) Farther Afield –**

For the more adventurous, this is a small sampling of the many good restaurants in Cincinnati. They were chosen to provide a variety of cuisine and dining experiences, as well as for relative proximity to the hotel. Menus for most of these restaurants are available in the **Menu Book** in the **Consuite**.

1. **Grand Finale**, Excellent food with a French accent, located in a Victorian tavern with additional courtyard seating. Hours: Lunch 11:15 am – 4 pm Tues – Sat, Dinner 4 pm – 9:30 pm Tues – Thurs 4 pm – 10:30 pm Fri -Sat, 4:30 pm - 9:30 pm Sun, Brunch 10:30 am – 2:30 pm on Sunday. Closed Monday. Directions: Take I-27: West to Route 747 south. Grande Finale is at the junction of 747 and Sharon Road in Glendale.

2. **Graeter's**, Cincinnati's Gourmet French crock ice cream, bakery, seating, Route 747, Hours 7 am –10:45 pm Mon - Thurs, am - 11 pm Fri-Sat., 9 am – 10:45 pm Sun. Directions: I-275 West to Route 747 south, Graeter's is on the right, south of Kemper Road.

3. **Pappadeux** Seafood with a New Orleans flair, outdoor patio with fountain, Hours: 11 am-10 pm, Sun-Thurs, 11 am – 11 pm Fri-Sat. Directions: I 275 west to Route 4 Springfield Pike, stay in the right lane, turn right in front of the cinema onto Pictoria Rd,

4. **Anand India**, Indian Food, 10890 Reading Rd.,Hours: 11 am – pm, Mon-Thurs, 12 pm – 3 pm, Fri-Sun., Dinner, 5 pm – 9:30 pm Mon-Sat, 4:30 pm – 9 pm Sun, Directions:I-275 west to exit 56, Highway 42. Follow Highway 42 south approximately 2.5 miles, Anand will be on the left.

5. **Blue Goose Sports Cafe**, 11060 Reading Rd.,Kitchen Hours: 11 am – 11 pm, Mon-Thurs, 11 am – 12 pm, Fri-Sat, 11 am – 10 pm Sun, Bar open til midnight Sun-Thurs, 2:30 am Fri -Sat, .Directions:I-275 west to exit 56, Highway 42. Follow Highway 42 south ~ 2 miles, Blue Goose will be on the left.

6. **Silver Spring House**, 8322 E. Kemper, Hours: 11 am – 11 pm Mon-Sat, Noon-9 pm Sun, Directions: Exit Left onto Kemper Rd , go 2 miles, the Spring House is at Snider Rd.
7. **DeSha's American Tavern**, 11320 Montgomery Rd, Hours: 11 am – 10 pm Mon-Thurs, 11 am – 11 pm Fri-Sat, live music 7 pm – 10 pm Thurs and 8 pm-11 pm Fri, 11 am – 9 pm Sun. Directions: I-275 East to Montgomery Road north to Harper's Point Shopping Center, DeSha's is on an outlot
8. **Johnny Chan 2**, 11296 Montgomery Rd, Hours: 11 am – 10 pm, Mon-Thurs, 11 am – 10:30 pm, Fri, 11:30 am -10:30 pm Sat, 11:30 am – 9 pm Sun. Directions: I-275 East to Montgomery Road north to Harper's Point Shopping Center, Johnny's is in the Center, on the right.
9. **Carrabba's Italian Grill**, Hours: 4 pm – 10 pm, Mon-Thurs, 3:30 pm – 11 pm Fri-Sat, noon – 9:30 pm Sun. Directions: I-275 east to I71 north to the Fields Ertel exit, Turn left at the exit, Carrabba's is .25 mile ahead on the left
10. **Mimi's Cafe**, Hours: 7 am – 11 pm, Daily Directions: I-275 east to I71 north to the Fields Ertel exit, Turn left at the exit, Mimi's Cafe is 1.25 miles ahead on the left, on an outlot of the Deerfield Shopping Center.
11. **Original Pancake House**, 9977 Monygomery Road, great specialty pancakes and breakfast foods, Hours: 7 am – 2 pm Mon-Fri, 7 am – 3 pm Sat-Sun, Directions:I-275 east to Montgomery Road south. The Pancake House will be ~ 1.25 miles south on the right , in a shopping mall.
12. **Montgomery Inn**, 9440 Montgomery Rd., Barbecue, ribs, Valet Parking in rear. Hours: 11 am – 10:30 pm Mon-Thurs, 11 am – 11 pm Fri-Sat, 3 pm - 10 pm Sun. Directions: I-275 East to Montgomery Rd south, the inn will be on the left, in the historic district.
13. **Cheescake Factory**, Kenwood Towne Center, specializes in cheesecakes, Hours: 11:30 am – 11 pm Mon-Thurs, 11:30 am – 12:30 am Fri-Sat, 10 am – 11 pm Sun, Directions:Take I-275 East to I-71 South to the Montgomery Road exit. Turn right at the exit and then right again into the Kenwood Towne center at the next traffic light. You will be facing the Cheesecake Factory.

# MILLENNICON 22

Science Fiction Convention

## MARCH 14-16, 2008

Guest of Honor

**Steven Barnes**

Featured Author

**Tananarive Due**

Filk Guest of Honor

**Tom Smith**

Featured Artist

**Mark Kantlehner**

\$30 until February 28, 2008

\$35 At the Door

Children 12 and Over Full Price

Children 6 to 11 \$10, 5 and Under Free

One Day Memberships:

Friday \$15, Saturday \$25, Sunday \$15

Gamers Pass: \$20 for the Weekend.

No Preregistrations after Feb. 28, 2008

\$79 Room Rate

For Hotel Reservations Call:

1-513-830-3030

MILLENNICON

PMB - 122, 5818 Wilmington Pike

Centerville, OH 45459

(513) 659-2558

Web Site:

<http://www.millennicon.org/>



COPYRIGHT © 1988 BY HORVA THAIKOS - ALL RIGHTS RESERVED

**The Holiday Inn Hotel  
Cincinnati, Ohio**

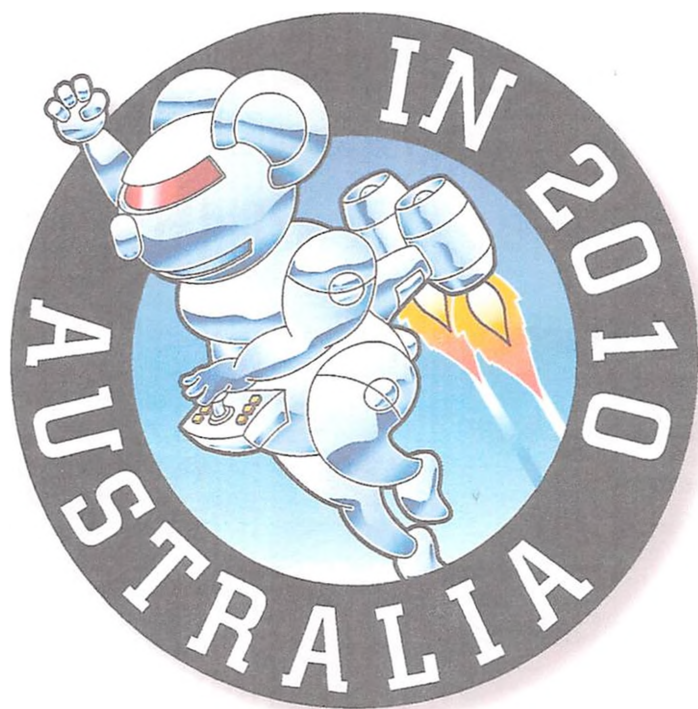

## It's time... let's do it again in 2010

Australia is bidding to hold its fourth World Science Fiction Convention and we'd like you to join us on a wild ride towards that goal. Australia has a reputation (gained from its three Aussiecons in 1975, 1985 and 1999) of producing intimate, compact Worldcons where everyone has a good time. Come and see us at our bid parties at LACon.

We'll pour you a glass and tell why you just have to be there.

### Committee

Chair: Perry Middlemiss  
Treasurer: Rose Mitchell  
General Committee:  
Stephen Boucher  
David Evans  
Janice Gelb  
Mark Linneman  
Alan Stewart  
Julian Warner

### US Agent

David Evans  
114 Shorebird Circle  
Redwood Shores  
CA 94065 5101  
USA

### UK Agents

Eve & John Harvey  
8 The Orchard  
Tonwell  
Herts  
UK SG12 0HR

### European Agent

Vince Docherty  
Koninginnegracht 75a  
2514 AH Den Haag  
The Netherlands

Committee contact address: GPO Box 1212, Melbourne, AUSTRALIA 3001

Email: [info@vsfc.org.au](mailto:info@vsfc.org.au)

Website: [www.australia2010.org/index.html](http://www.australia2010.org/index.html)

This bid is supported by Melbourne Convention + Visitors Bureau.